

ALL MEASUREMENTS ARE IN MILLIMETRES | MANUFACTURED FROM MILD STEEL

5M7, 6M7, 7M7

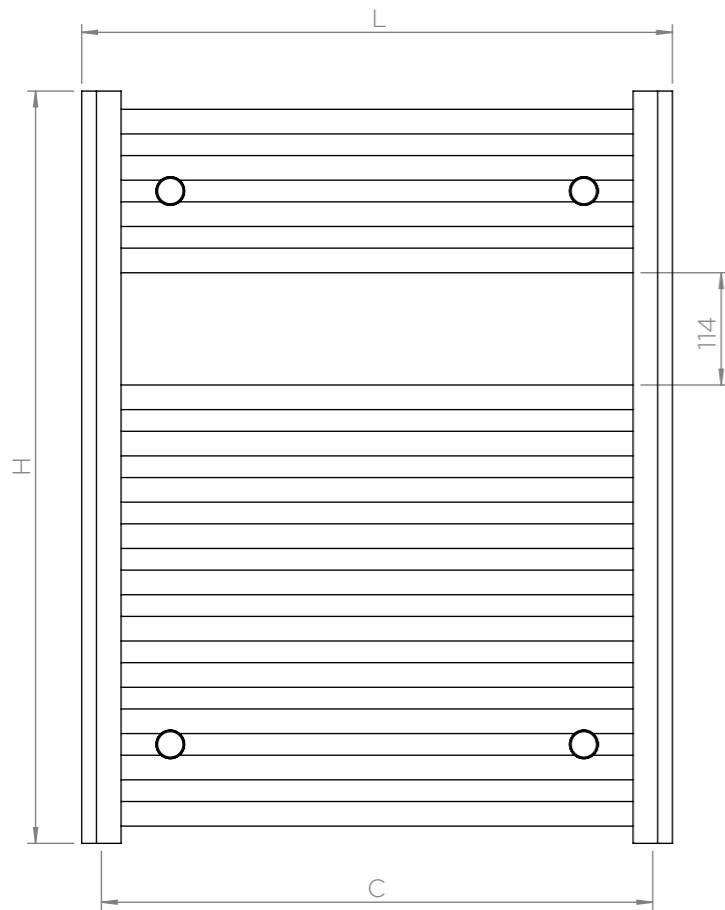

Front View

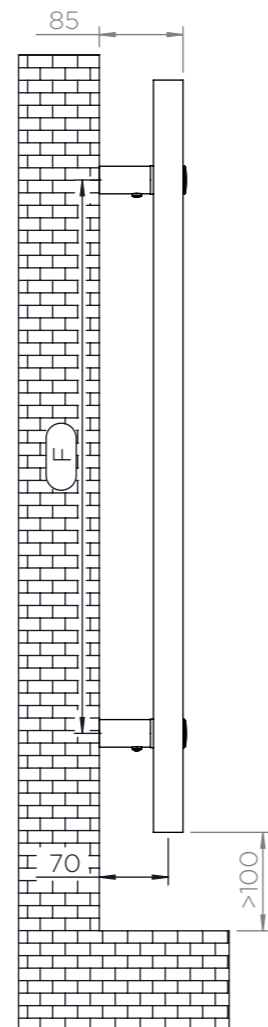

Side View

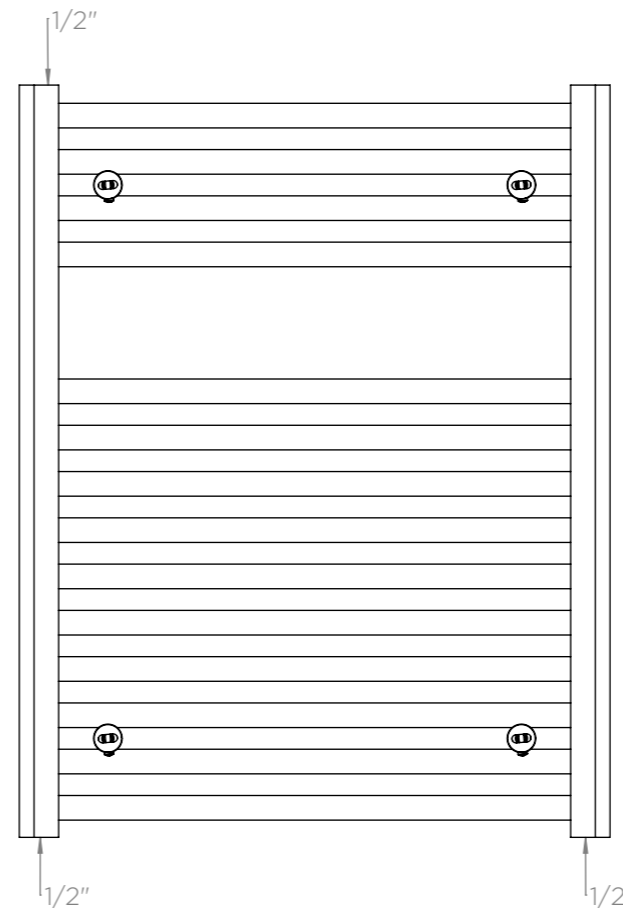

Back View

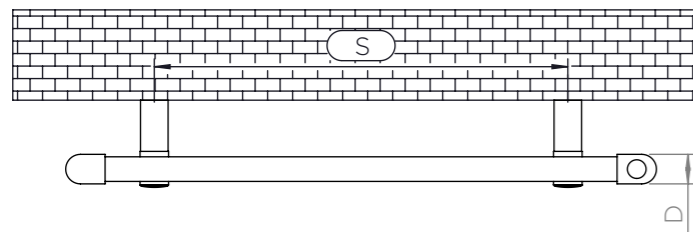
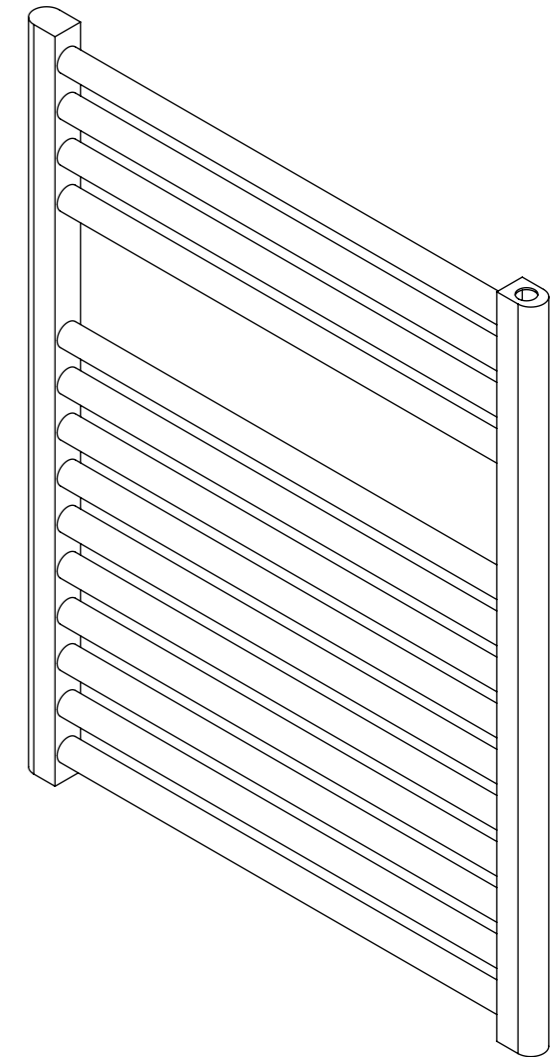

Top View

Plumbing Position:
Vertical Mount

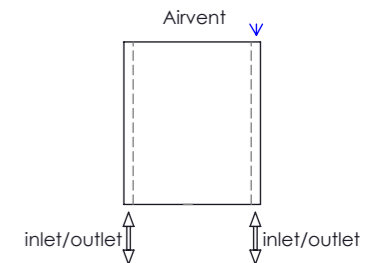

All Dimension are in mm
 Max.Working Pressure: 10 Bar
 Max.Working Temperature: 95° C
 Inlet / Outlet : 1/2" BSP
 Fuel: E/H/D
 Ø25x1.2 mm Hor. Tubes
 30x40x1.5 mm Vert. Profiles

Installation Accessories:

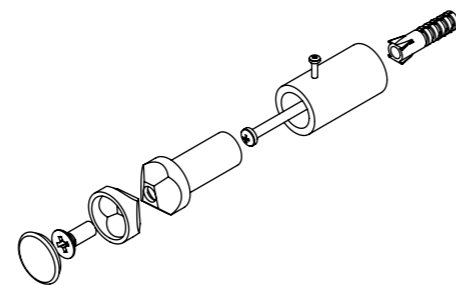
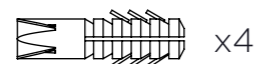
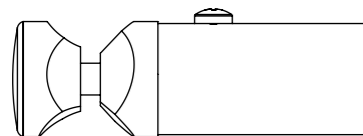

| PRODUCT CODE | HEIGHT (H) | LENGTH (L) | DEPTH (D) | PIPE CENTRES (C) | BRACKET CENTRES | |
|--------------|------------|------------|-----------|------------------|-----------------|-----|
| | mm | mm | mm | | F | S |
| 5M7 | 764 | 500 | 30 | 460 | 562 | 320 |
| 6M7 | 764 | 600 | 30 | 560 | 562 | 420 |
| 7M7 | 764 | 750 | 30 | 710 | 562 | 570 |