

ALL MEASUREMENTS ARE IN MILLIMETRES MANUFACTURED FROM MILD STEEL

5IM13, 5IM18

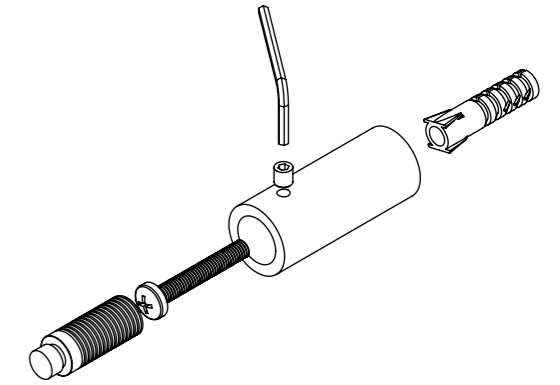

Plumbing Position: Vertical

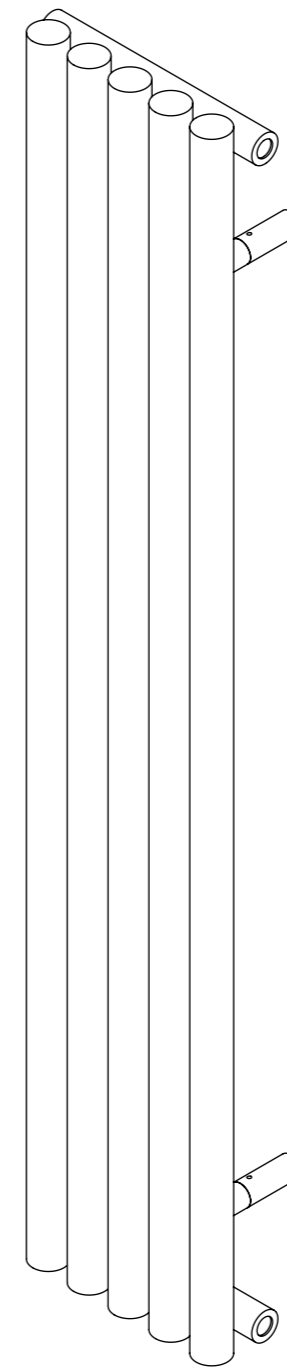
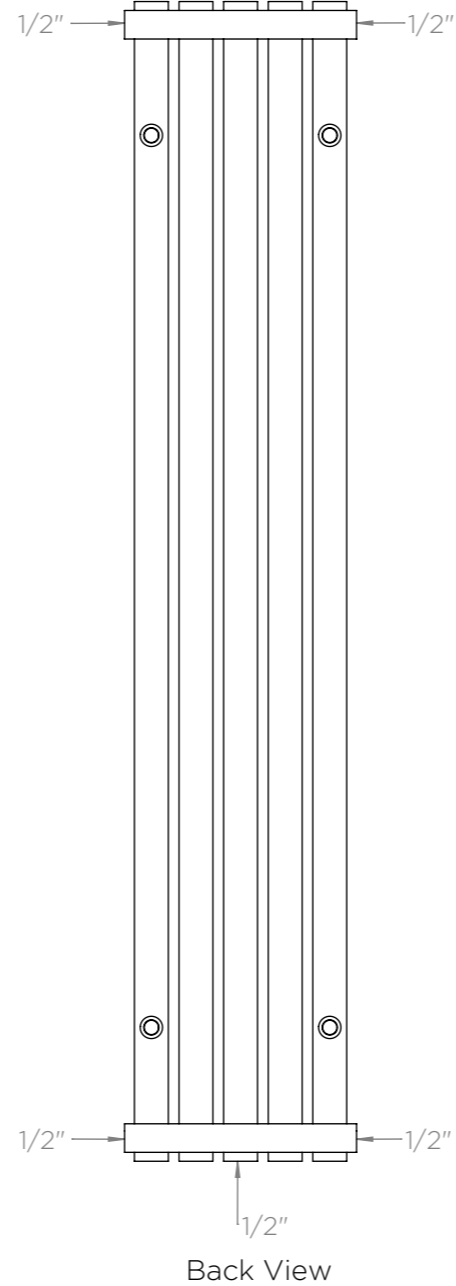
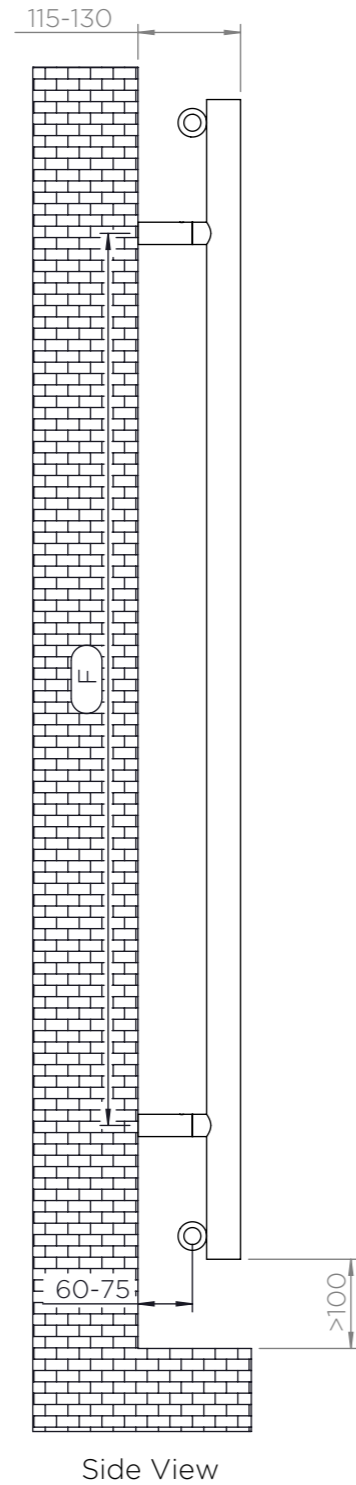
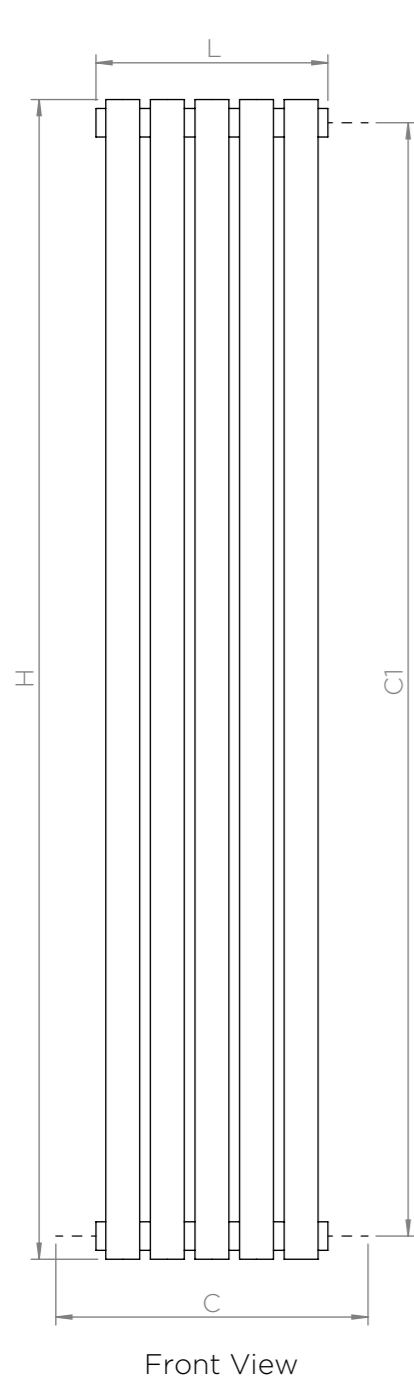
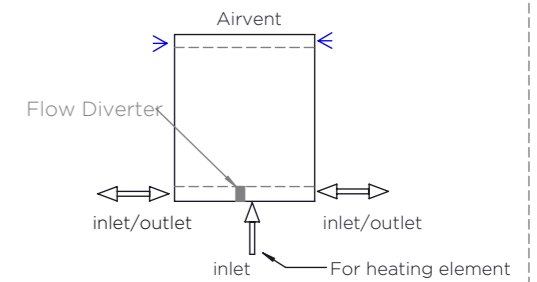

When mounting vertically, please observe that the collector fitted with a flow diverter is mounted at the bottom. This can be verified by visually checking or by referring to the installation diagram.

Plumbing Position: Horizontal

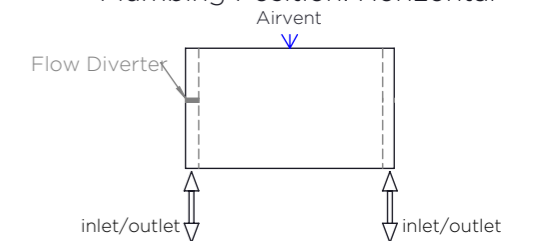

When mounting horizontally, please knock through the centre hole of the diverter using a suitable rod. Please remove the disk if it comes loose and can be removed from a tapping.

All Dimension are in mm
 Max.Working Pressure = 6 Bar
 Max.Working Temperature=95° C
 Inlet / Outlet : 1/2" BSP

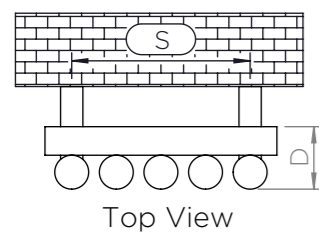

Installation Accessories:

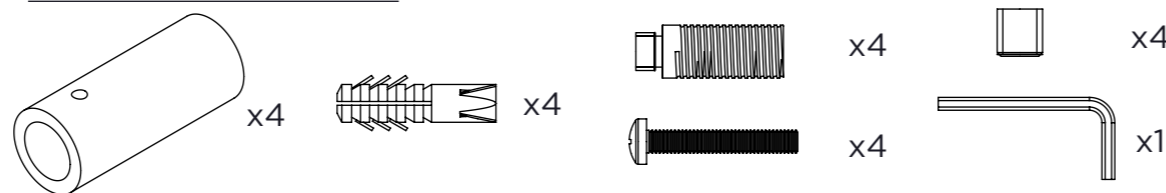

PRODUCT CODE	HEIGHT (H)	LENGTH (L)	DEPTH (D)	PIPE CENTRES (C)	BRACKET CENTRES	
	mm	mm	mm		F mm	S mm
5IM13	1300	260	70	350-1248	1000	200
5IM18	1800	260	70	350-1748	1500	200