

ALL MEASUREMENTS ARE IN MILLIMETRES MANUFACTURED FROM STAINLESS STEEL

VS2-09/21

## 5BE

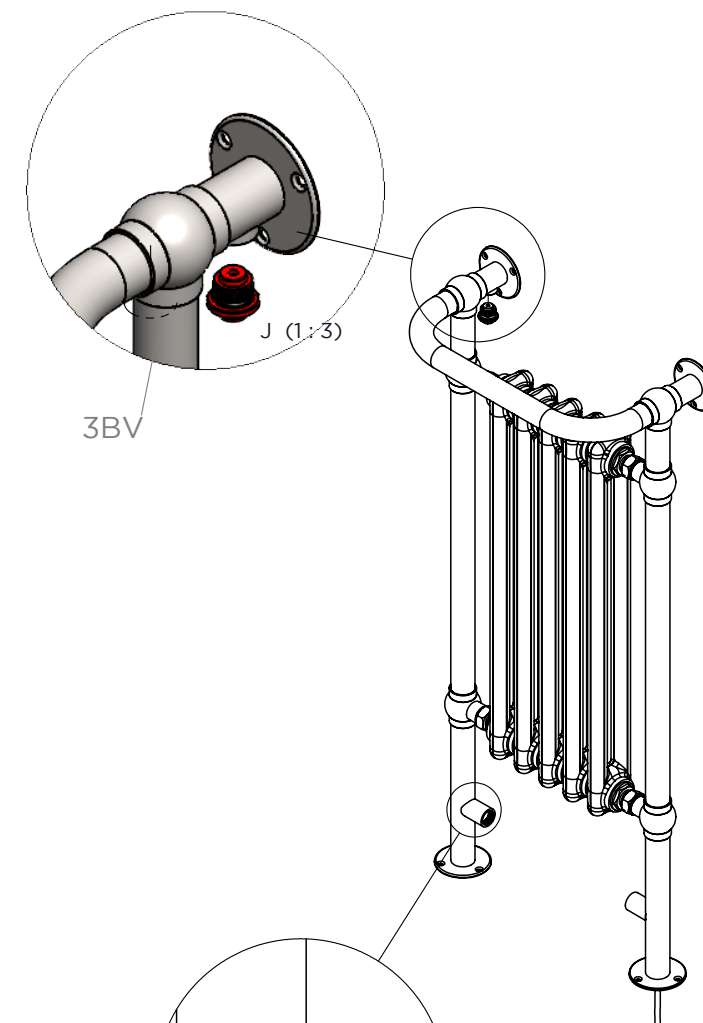
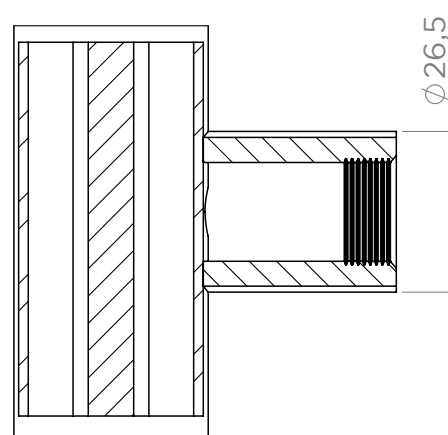
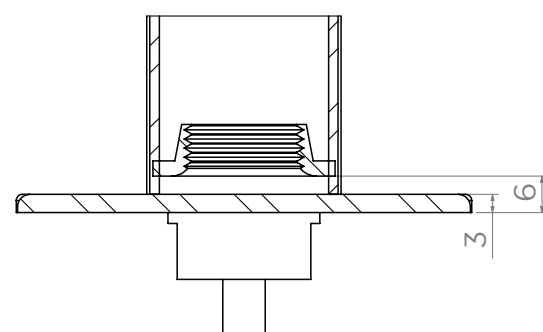
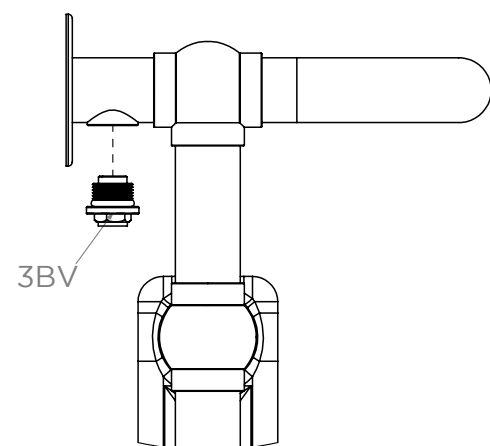
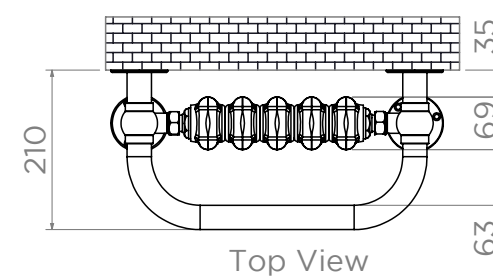
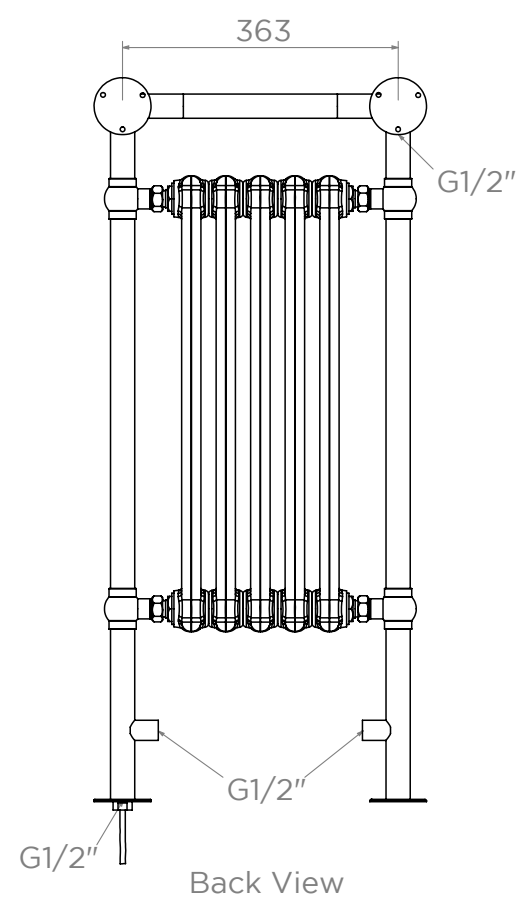
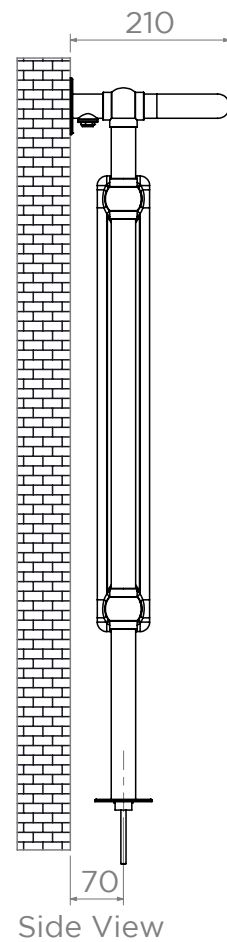
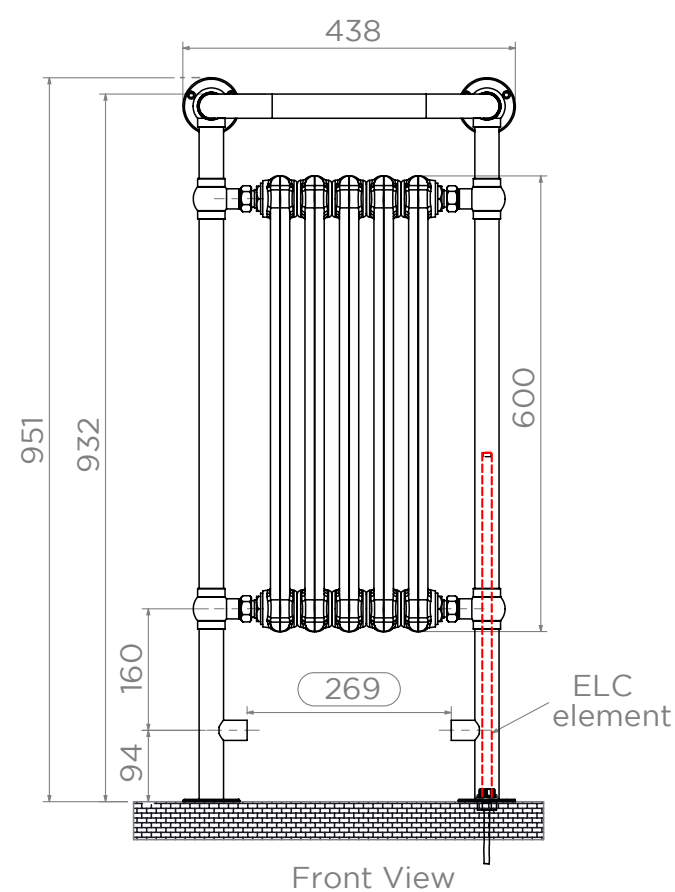

FITTING POSITION:

Airvent

INSTALLATION ACCESSORIES:

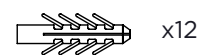

inlet/outlet ≤ inlet/outlet  
Elc

Max.Working Pressure = 8 Bar  
Max.Working Temperature= 95° C  
Inlet / Outlet : 1/2" BSP