

# CHELMSFORD

(5MA11-6MA11-7MA11)

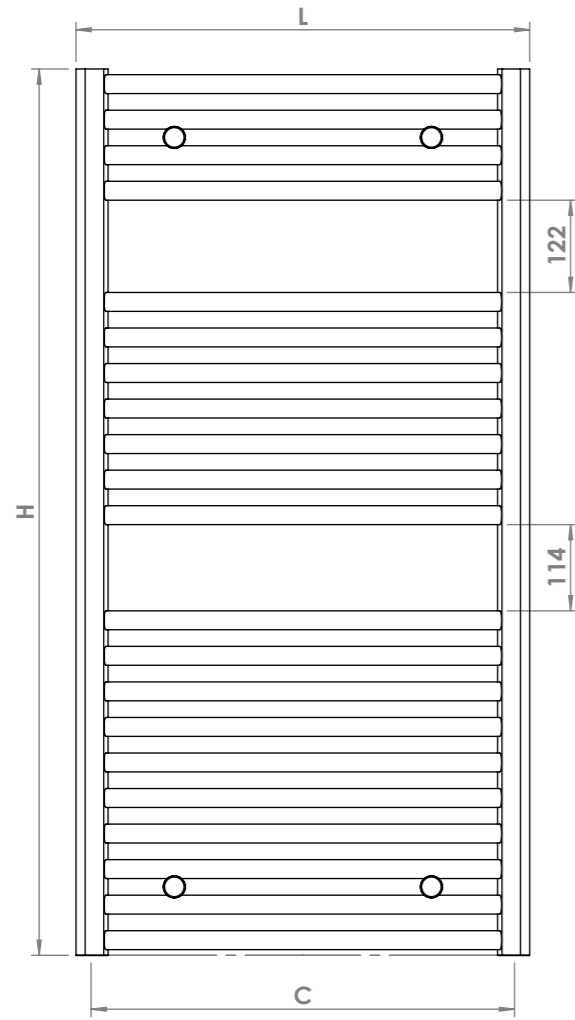

Front View

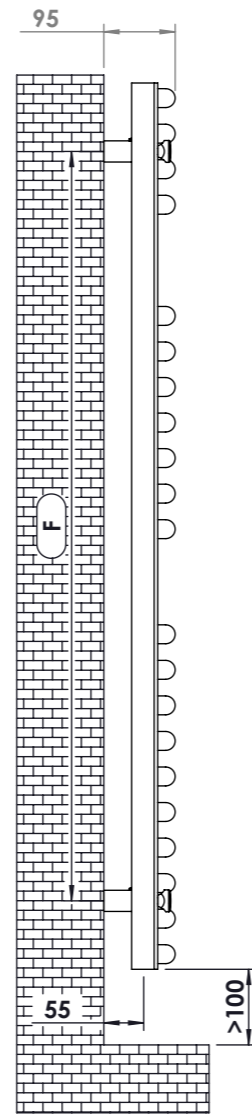

Side View

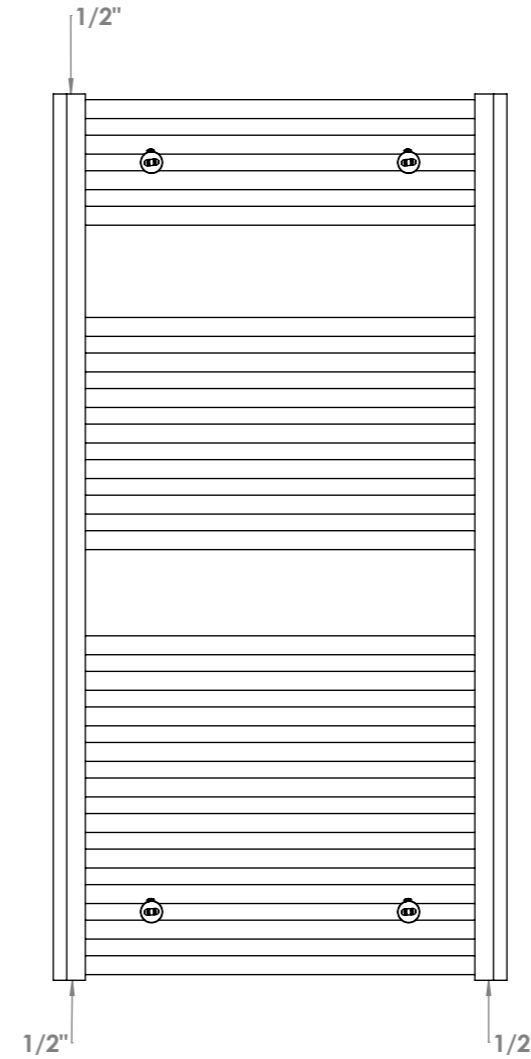

Back View

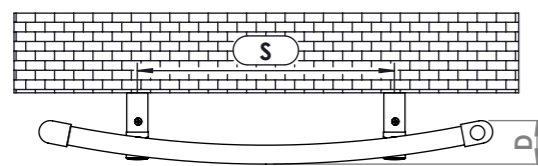
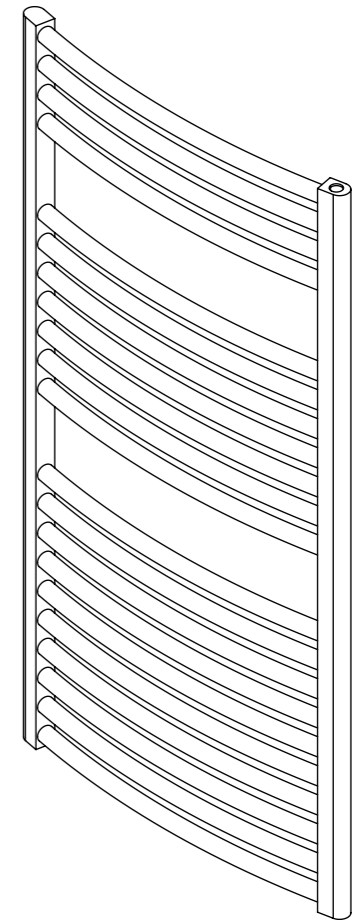

Top View

### Plumbing Position: Vertical

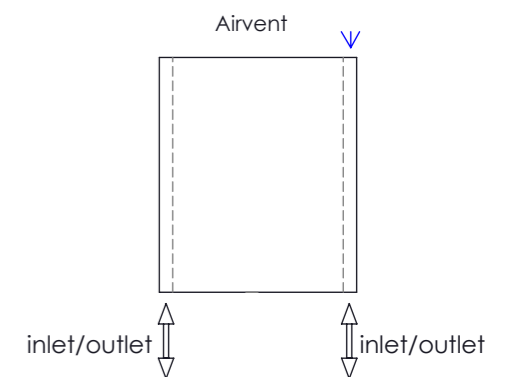

### Installation Accessories:

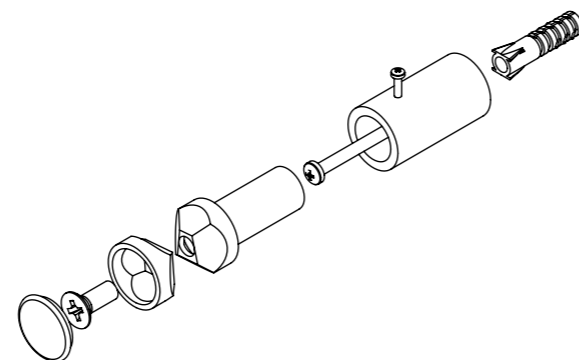
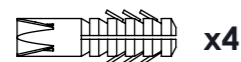
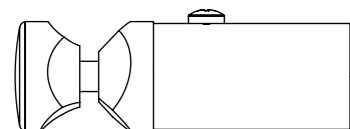

Vertical mount  
 All Dimensions are in mm  
 Max. Working Pressure: 10 Bar  
 Max. Working Temperature: 95° C  
 Inlet / Outlet : 1/2" BSP  
 Fuel : E/H/D  
 Ø25x1.2 mm Hor. Tubes  
 30x40x1.5 mm Vert. Profiles

PRODUCT CODE	Height	Length	Depth	Pipe Centres	Bracket Centres	
	H mm	L mm	D mm	C mm	F mm	S mm
5MA11	1172	500	60	460	991	240
6MA11	1172	600	65	560	991	340
7MA11	1172	750	70	710	991	490