

# CHELMSFORD

(5M11-6M11-7M11)

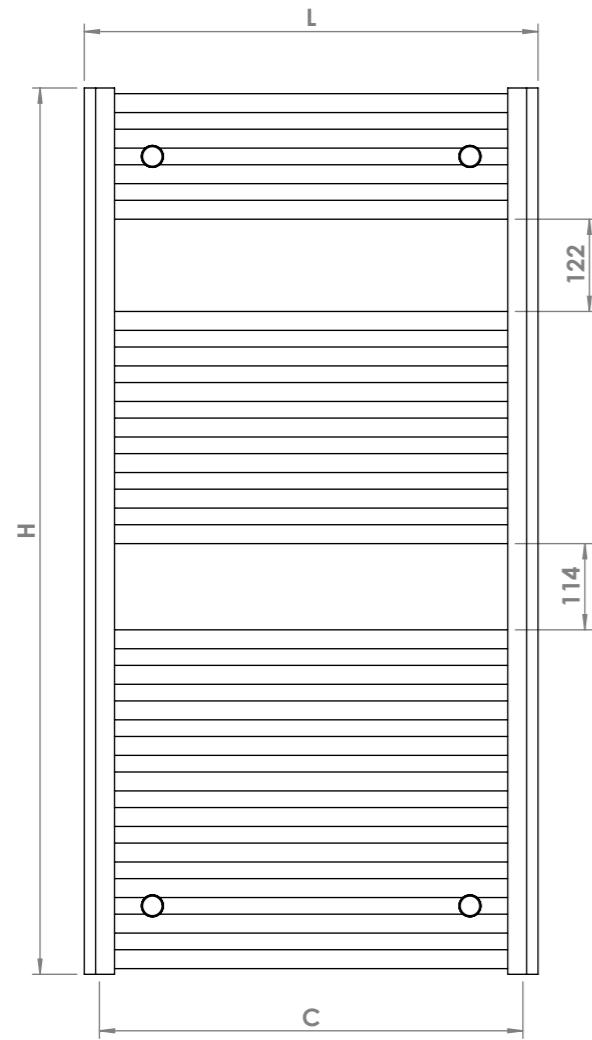

Front View

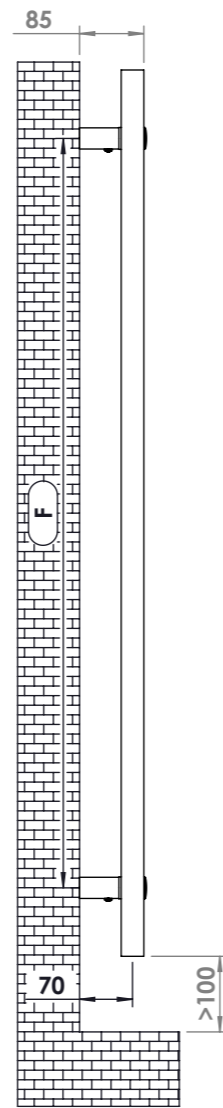

Side View

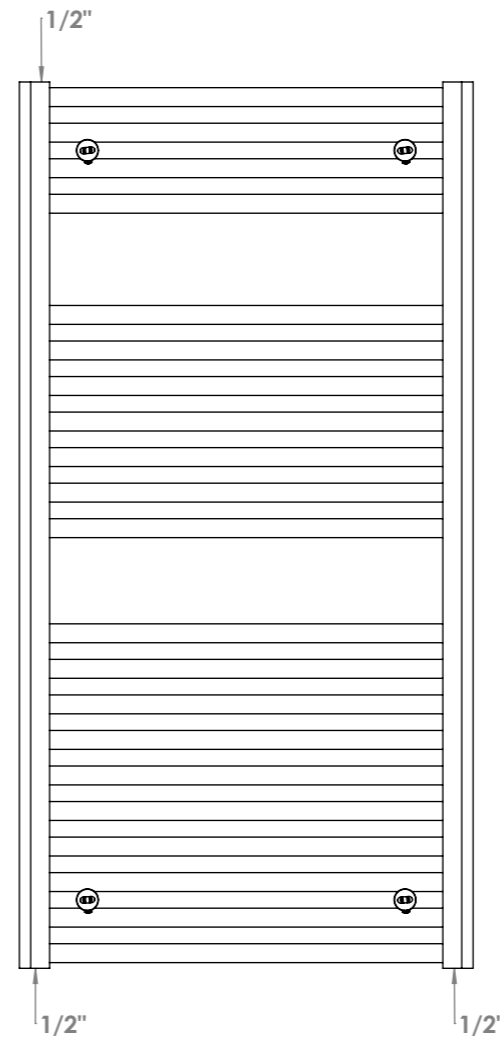

Back View

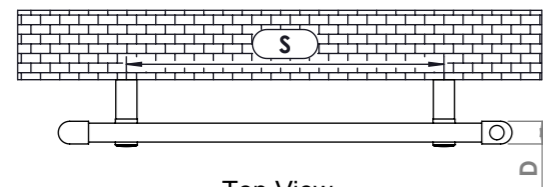
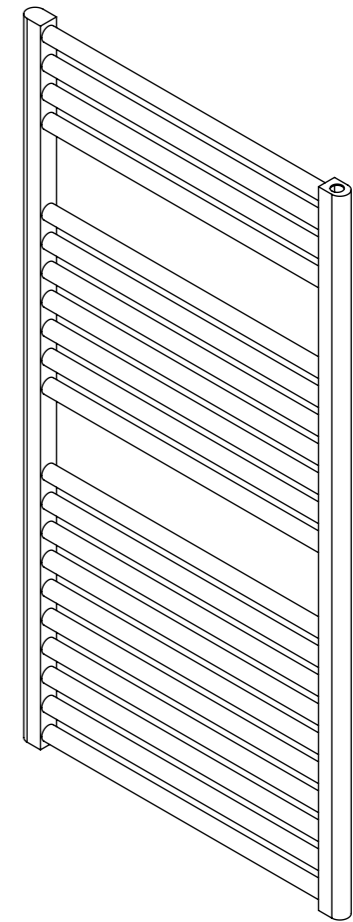

Top View

### Plumbing Position: Vertical

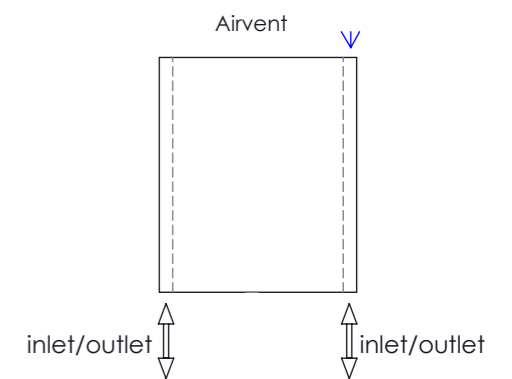

### Installation Accessories:

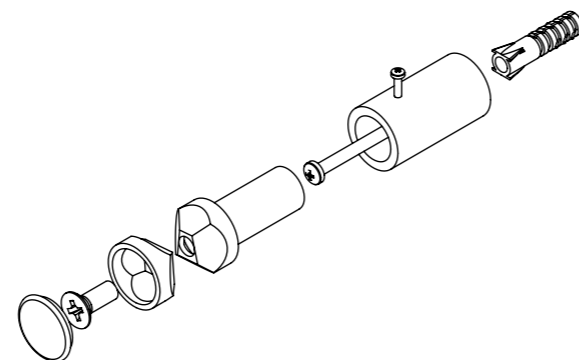
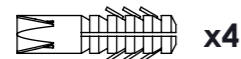
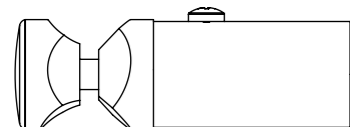

Vertical mount  
 All Dimensions are in mm  
 Max.Working Pressure: 10 Bar  
 Max.Working Temperature: 95° C  
 Inlet / Outlet : 1/2" BSP  
 Fuel : E/H/D  
 Ø25x1.2 mm Hor. Tubes  
 30x40x1.5 mm Vert. Profiles

| PRODUCT CODE | Height  | Length  | Depth   | Pipe Centres | Bracket Centres |         |
|--------------|---------|---------|---------|--------------|-----------------|---------|
|              | H<br>mm | L<br>mm | D<br>mm | C<br>mm      | F<br>mm         | S<br>mm |
| 5M11         | 1172    | 500     | 30      | 460          | 991             | 320     |
| 6M11         | 1172    | 600     | 30      | 560          | 991             | 420     |
| 7M11         | 1172    | 750     | 30      | 710          | 991             | 570     |