

# CHELMSFORD (4M12)

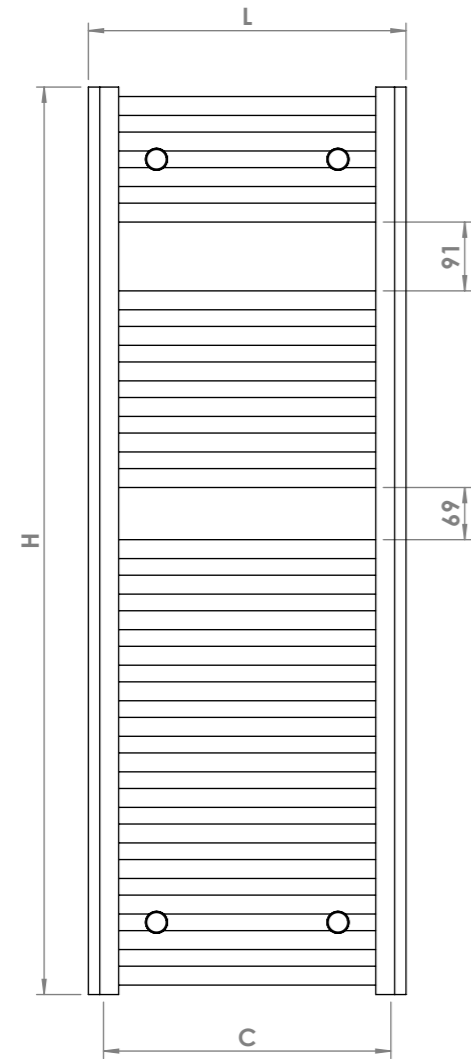

Front View

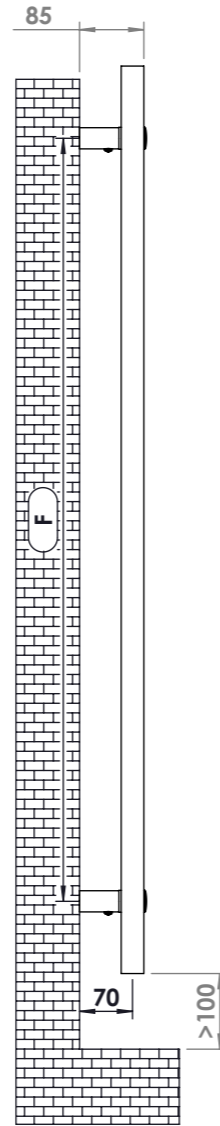

Side View

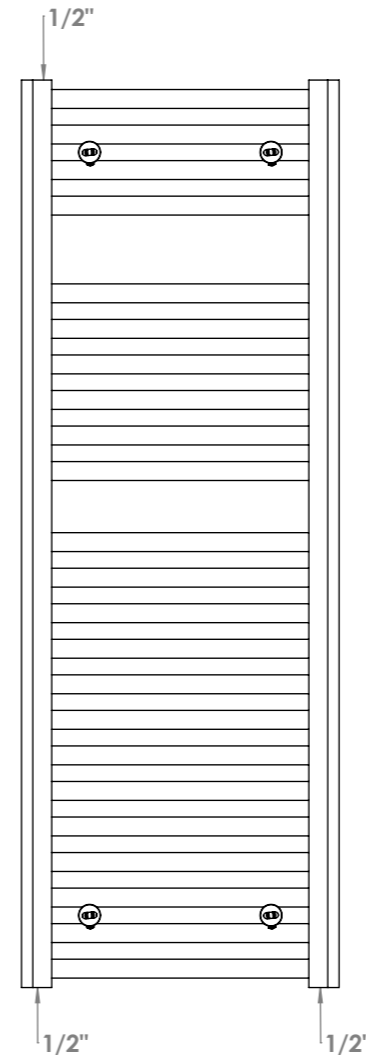

Back View

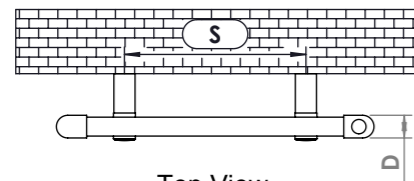
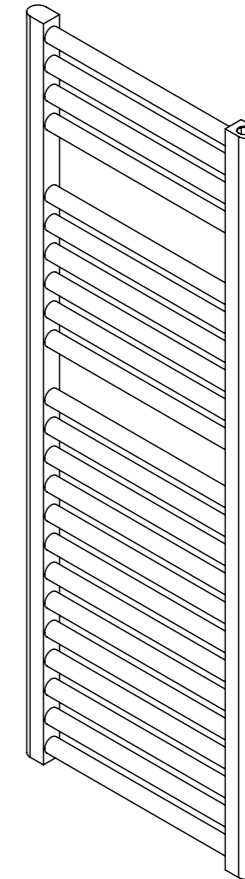

Top View

### Plumbing Position: Vertical

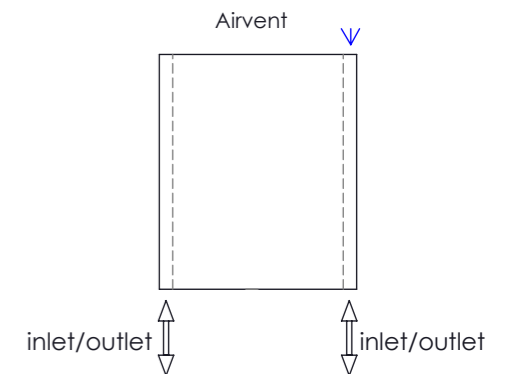

### Installation Accessories:

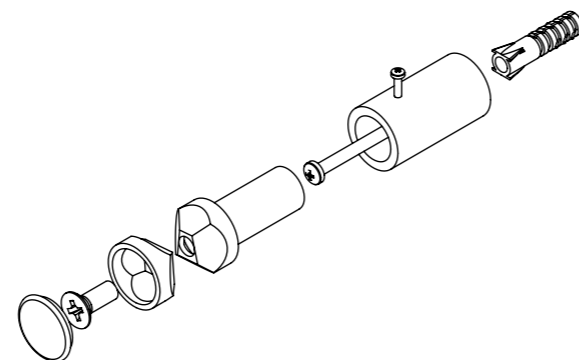
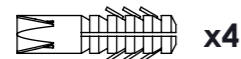
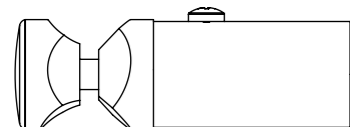

Vertical mount  
All Dimensions are in mm  
Max.Working Pressure: 10 Bar  
Max.Working Temperature: 95° C  
Inlet / Outlet : 1/2" BSP  
Fuel : E/H/D  
Ø25x1.2 mm Hor. Tubes  
30x40x1.5 mm Vert. Profiles

PRODUCT CODE	Height	Length	Depth	Pipe Centres		Bracket Centres	
	H mm	L mm	D mm	C mm	F mm	S mm	
4M12	1200	420	30	380	1009	240	